

Mechanical Dimensions: Inches [mm]

Tolerances ± 0.012 [0.3] Unless Otherwise Specified

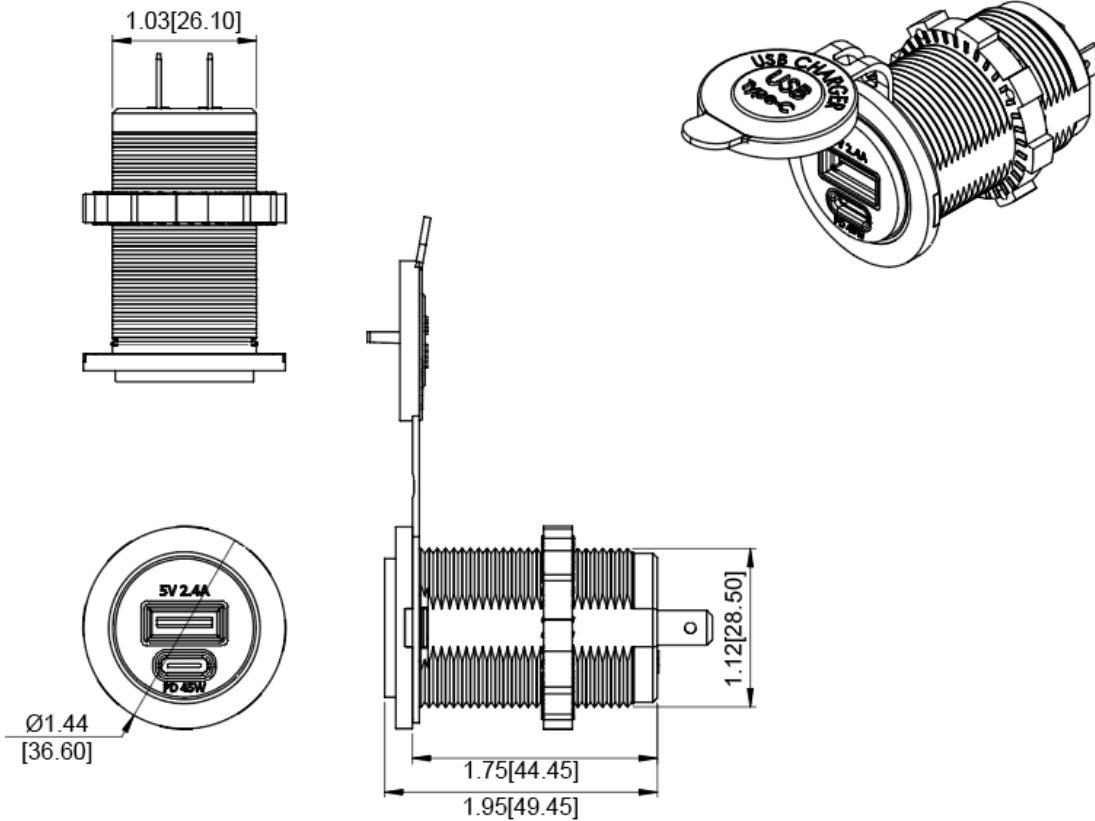

Mounting Hole

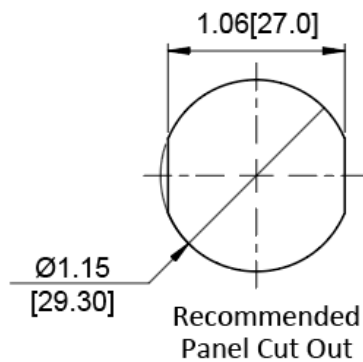

Electrical Specifications

Input Rating	12/24V
Output rating (12VDC input)	Type A output: 5V 2.4A Type C PD output: 5V-12V; 36W max Type A + C output: 5V 2.4A + 5V 2.4A
Output rating (24VDC input)	Type A QC output: 5V 2.4A Type C PD output: 5V-20V; 45W max Type A + C output: 5V 2.4A + 5V 2.4A

USB-A & PD (Power Delivery) USB-C

Includes OVP, OCP, OTP, SCP, and RPP

Material Specifications

Smart LED Indicator: Blue for 5V charging, orange for PD fast charging

Ingress Protection IP65
(When not in use and cap is securely closed)

Rev Date of issue Revision Notes

Designed Approved

F	05-20-2025	Updated Electrical Specifications	RC	OF
---	------------	-----------------------------------	----	----