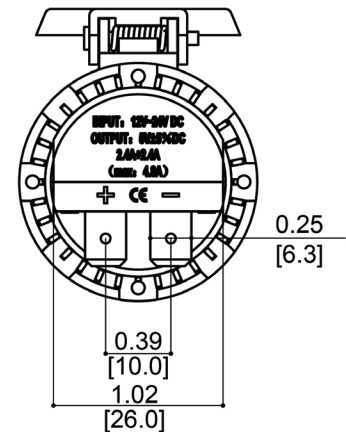
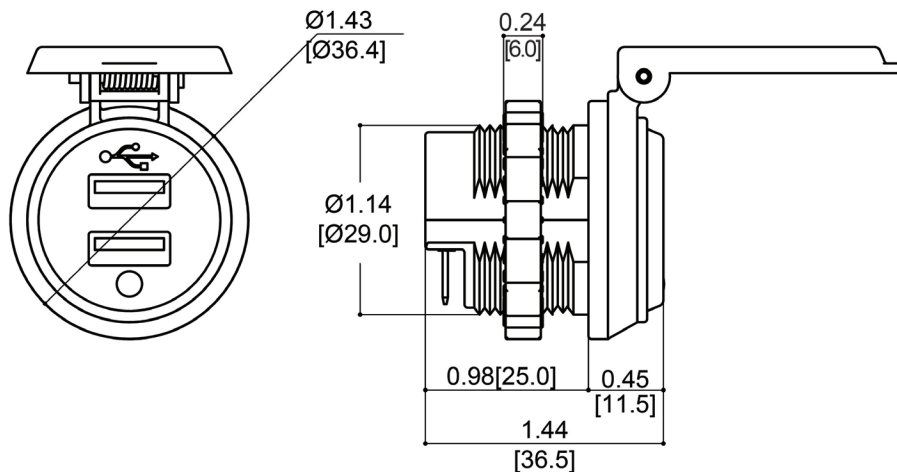
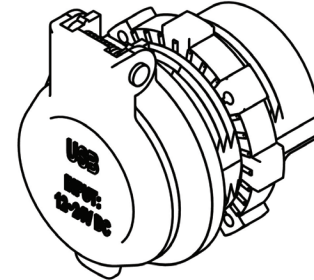
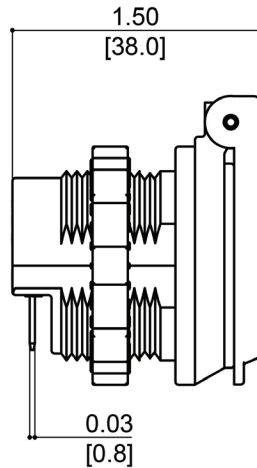
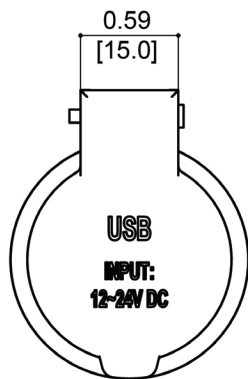

## Mechanical Dimensions: Inches [mm]

Tolerances  $\pm 0.012$  [0.3] Unless Otherwise Specified

## Electrical Specifications

Nominal Voltage	12/24VDC
Operating Voltage	12V/30VDC (max)
Peak Voltage	32VDC (max) (3~4 sec)
Output Rating (12VDC Input)	Type A output 1: 5V 2.4A Type A output 2: 5V 2.4A Type A + A output: 5V 2.4A + 5V 2.4A (4.8Amax)
Output Rating (24VDC Input)	Type A output 1: 5V 2.4A Type A output 2: 5V 2.4A Type A + A output: 5V 2.4A + 5V 2.4A (4.8Amax)
Operating Frequency	100~150Khz
Current Draw	20mA
Operating Temperature	-20 °C ~ 60 °C

Includes OVP, OCP, OTP, SCP, and RPP

## Material Specifications

Two Type A USB Connections

Terminals Material Brass

Body Material Reinforced Nylon

Mounting Hole 29mm diameter

LED Power Indicator

Ingress Protection IP65 when (When not in use and cap is securely closed)

Power Adapter - USB Socket

A10-USB2-1-B-4.8A



Rev	Date of issue	Revision Notes	Designed	Approved
E	05-20-2025	Initial Drawing	RC	OF