

Mechanical Dimensions: Inches [mm]

Tolerances ± 0.012 [0.3] Unless Otherwise Specified

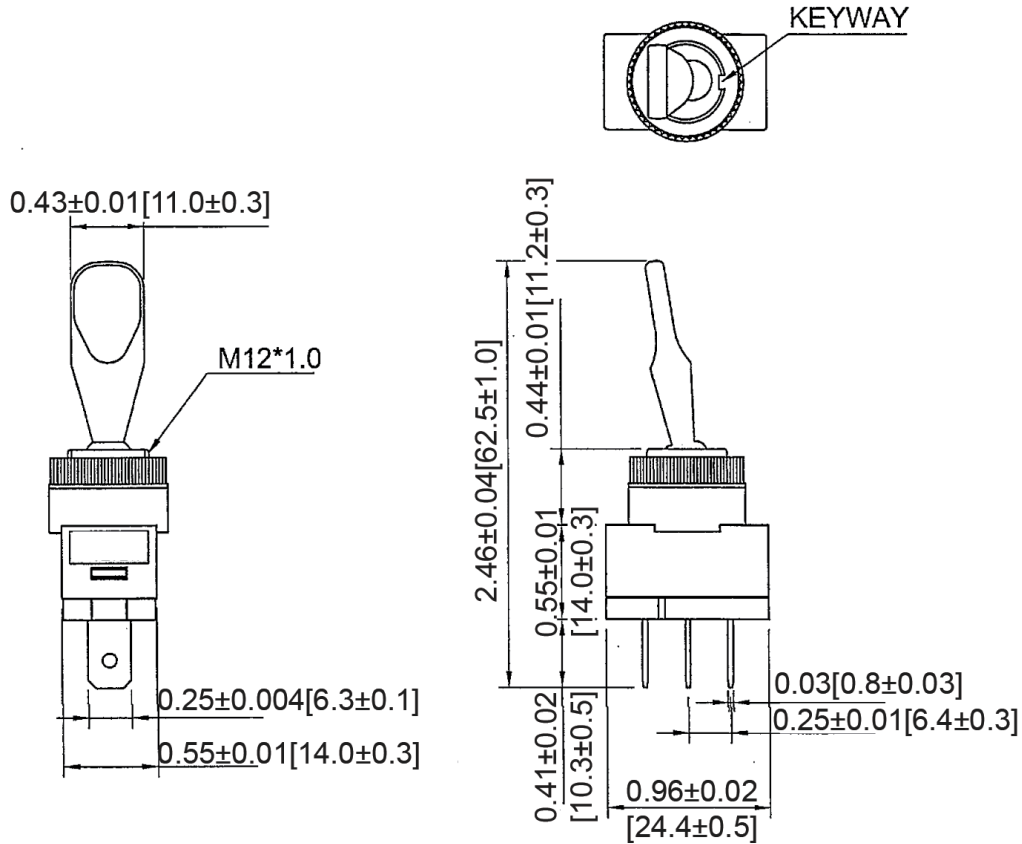

Mounting Hole

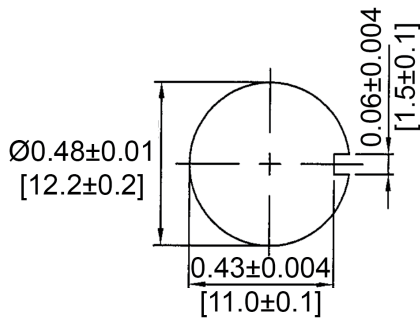

Circuit Diagram

3P SPST OFF-ON (Bulb-D)

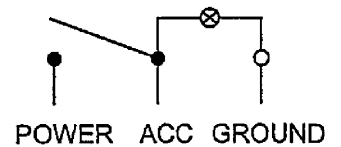

Electrical Specifications

Rating	20A 12V DC
Contact Resistance	50m ohm Max
Insulation Resistance	DC 500V 100M ohm Min
Dielectric Strength	AC 1500V 1 minute
Operation Temperature	-20°C~85°C

Material Specifications

Handle Color	Red

Rev	Date of issue	Revision Notes	Designed	Approved
C	09-26-2023	add operation temperature	RC	OF