

Mechanical Dimensions: Inches [mm]

Tolerances ± 0.012 [0.3] Unless Otherwise Specified

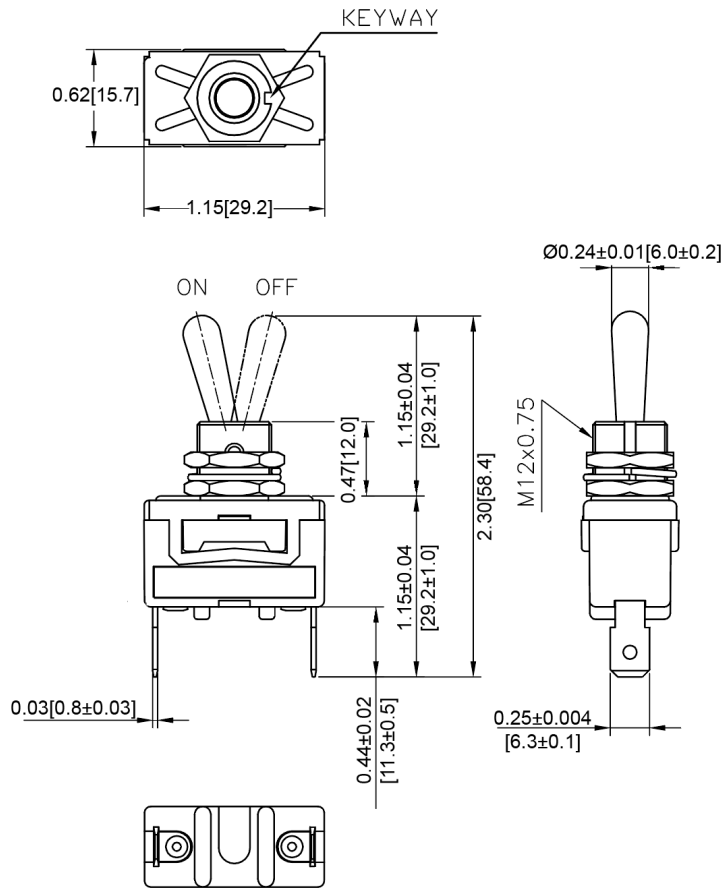

Mounting Hole

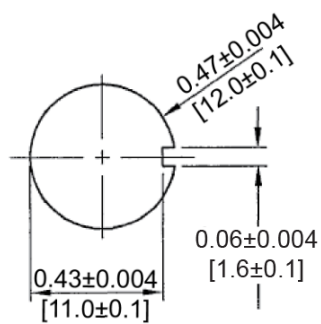

Thickness: 0.24[6.0mm]max

Circuit Diagram

2P SPST ON-OFF

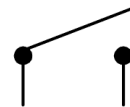

Electrical Specifications

Rating 15A 125VAC 1/8HP,
10A 250VAC 1/3HP

Contact Resistance 50m ohm Max

Insulation Resistance DC 500V 100M ohm Min

Dielectric Strength AC 1500V 1 minute

Material Specifications

2 Hex Nut Assy

1 Spring Washer Assy

Rev	Date of issue	Revision Notes	Designed	Approved
B	03-12-2020	Initial Drawing	RC	OF